

# LANDSCAPING CONCEPT

**Entry area:** will feature lots of palms and feature plants to provide a strong first impression upon entering

**Roadside planting:** tall coco palms create a 'boulevard' effect and providing a buffer with the neighbouring plots. Planting below is lush but also very water efficient as the area is fully exposed to the sun

**Oceanfront planting:** informal planting in keeping with the riparian habitat and focused around plants which thrive in full sun and on the ocean front. The effect will be very natural, with lots of coco palms, large areas of sand and buffer zones to provide privacy and security around the villas and the pool

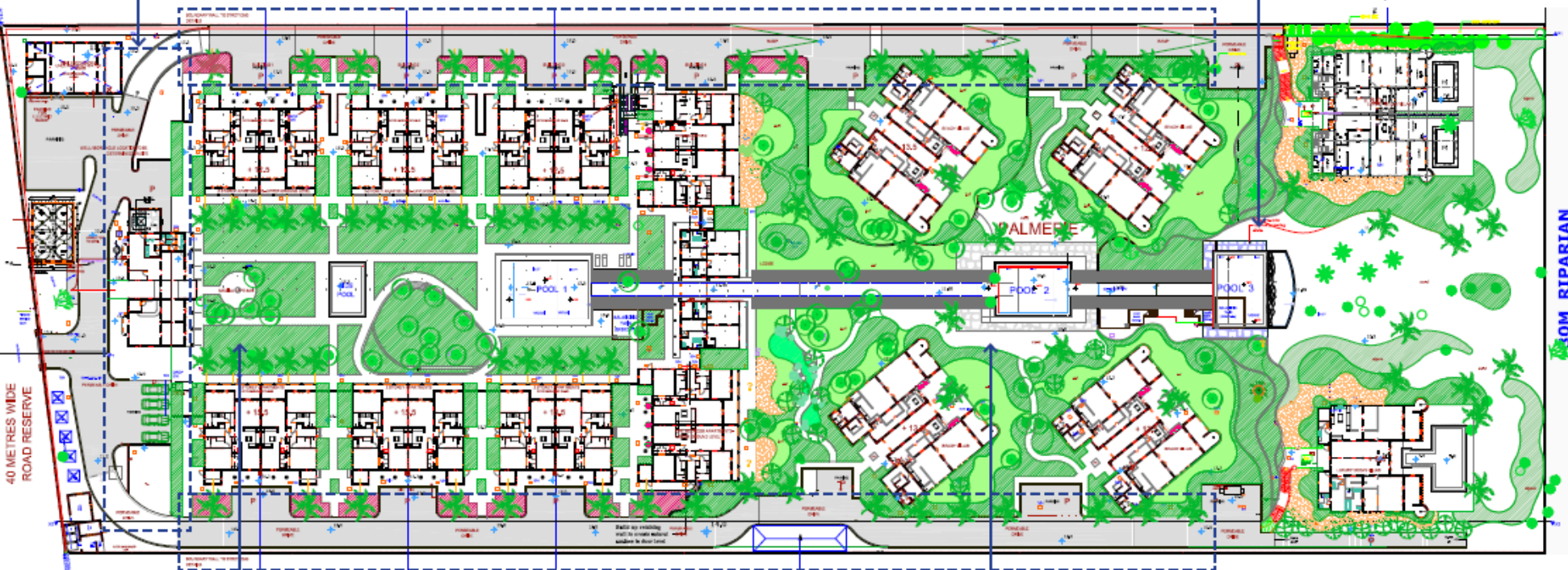

**Medina planting:** a formal pathway layout provides easy circulation. Trees will be placed to provide privacy around pools and buildings. Planting will be a mix of tropical and mediterranean

**Roadside planting:** tall coco palms create a 'boulevard' effect and providing a buffer with the neighbouring plots. Planting below is lush but also very water efficient as the area is fully exposed to the sun

**Palmerie planting:** the protected and mostly shady area lends itself to a lush tropical landscape with winding walkways, patches of turf and organically shaped planted areas